

FIRST CLASS MARZO 2006

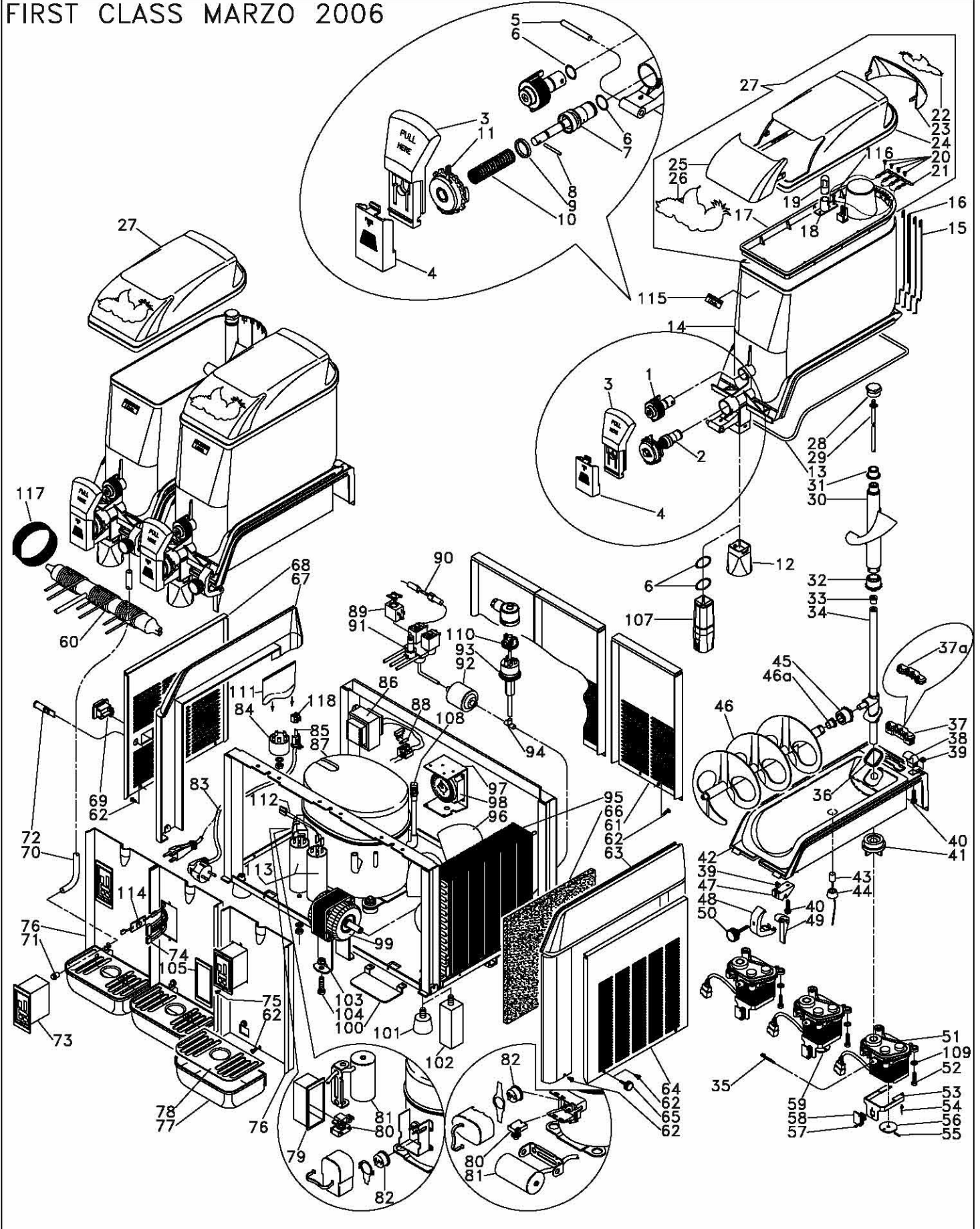

FIRST CLASS REFILL FEBBRAIO 2006

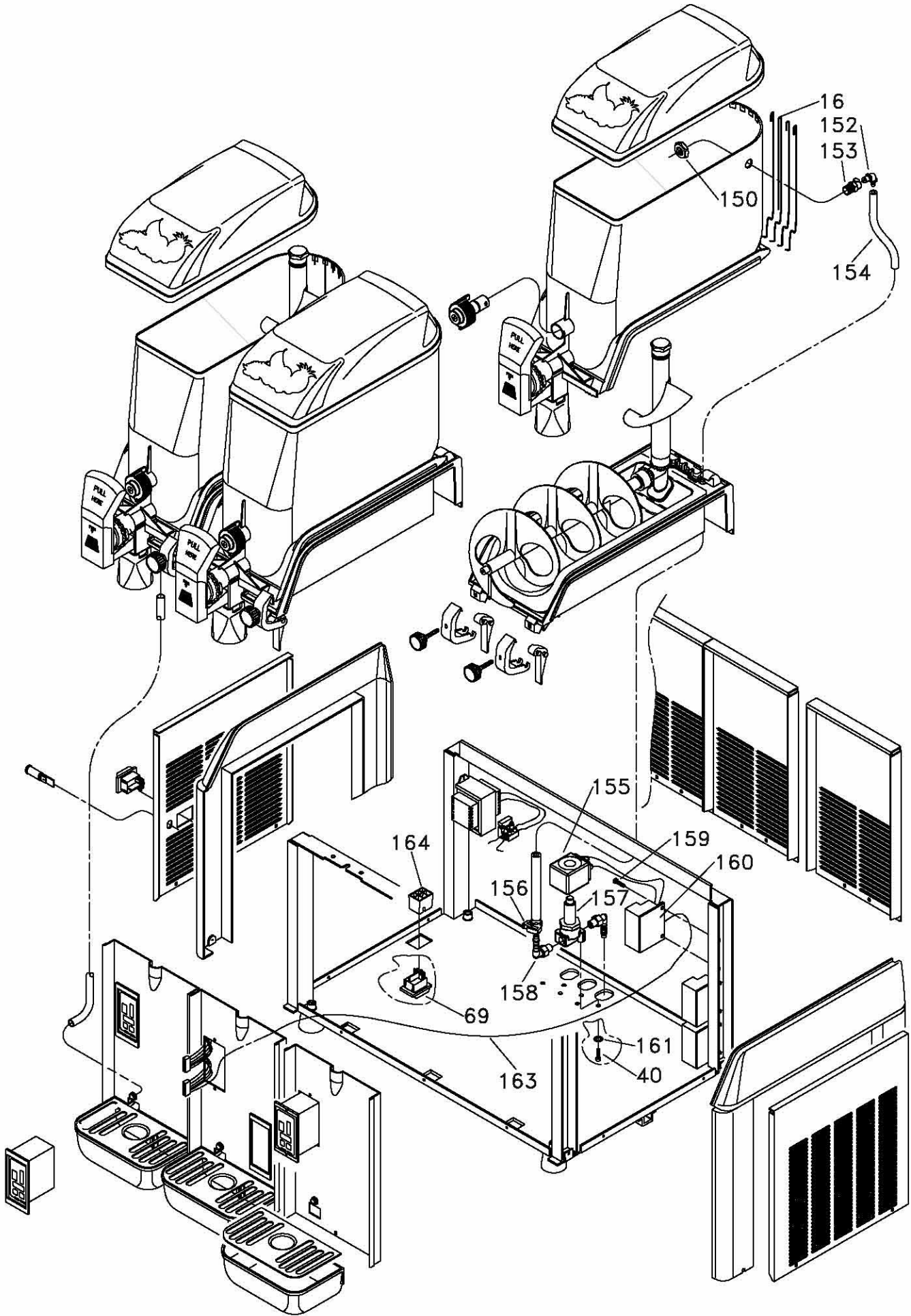

Part #	DESCRIPTION	FC1	FC2	FC3	115/60	MFG. #	Retail
1	RING NUT HORIZONTAL AUGER	*	*	*	*	M0004109-001	\$44.52
2	RING NUT LEVER COVER PISTON	*	*	*	*	M0003126-001	\$59.36
3b	GRAY HANDLE	*	*	*	*	M0003104-002	\$44.52
3c	BLACK HANDLE	*	*	*	*	M0003104-003	\$44.52
3d	BLACK HANDLE "PULL HERE"	*	*	*	*	M0003125-001	\$44.52
4b	GRAY LID HANDLE COVER	*	*	*	*	M0003108-002	\$17.80
4c	BLACK LID HANDLE COVER	*	*	*	*	M0003108-003	\$17.80
5	PIN DRAIN LEVER	*	*	*	*	M0003124-001	\$5.94
6	O-RING 117	*	*	*	*	OR13000117	\$1.50
7	ROD UNIT	*	*	*	*	M0003121-001	\$17.80
8	DOWEL ϕ 3X28MM	*	*	*	*	PERNO3X28ACCAI	\$4.12
9	OUTLET BACK GASKET	*	*	*	*	M0003117-001	\$3.22
10	PISTON SPRING	*	*	*	*	M0003106-001	\$7.42
11	RING NUT-LEVER-COVER	*	*	*	*	M0003120-001	\$18.06
12	DISPENSING SPOUT CUP VERSION	*	*	*	*	M0006134-002	\$15.20
13	GASKET TRANSPARENT TANK	*	*	*	*	M0000106-001	\$13.54
14	TRANSPARENT TANK COMPLETE OF PIN DRAIN LEVER	*	*	*	*	M0000147-001	\$150.00
15	LOW VOLTAGE CONTACT WIRE	*	*	*	*	M0005111-001	\$9.04
16	PROBE LEVEL CONTACT	*	*	*	*	M0005128-001	\$10.32
17	LAMP GLASS	*	*	*	*	M0006108-001	\$59.36
18	LAMP SOCKET	*	*	*	*	M0005133-001	\$13.80
19	LAMP 10Watt/12Vac	*	*	*	*	LAMPADA10W	\$4.50
20	SCREW TC 2.9X9.5	*	*	*	*	VTTC2.9X9.5CR	\$0.78
21	12V CONTACT FOR TANK	*	*	*	*	M0005109-001	\$6.46
22	BACK PLASTIC LENS STICKER	*	*	*	*	M0006129-001	\$16.32
23	BACK TOP LIGHT DISPLAY	*	*	*	*	M0006121-001	\$29.68
24a	GREEN TOP LIGHT	*	*	*	*	M0006105-001	\$89.02
24b	GRAY TOP LIGHT	*	*	*	*	M0006105-003	\$89.02
24c	BLACK TOP LIGHT	*	*	*	*	M0006105-004	\$89.02
25	FRONT TOP LIGHT DISPLAY	*	*	*	*	M0006120-001	\$29.68
26	FRONT PLASTIC LENS STICKER	*	*	*	*	M0006128-001	\$16.32
27a	GREEN TOP LIGHT COVER COMPLETE	*	*	*	*	M0006125-001	\$133.54
27b	GRAY TOP LIGHT COVER COMPLETE	*	*	*	*	M0006125-003	\$133.54
27c	BLACK TOP LIGHT COVER COMPLETE	*	*	*	*	M0006125-005	\$133.54
28	RING NUT VERTICAL PROPELLER	*	*	*	*	M0000107-001	\$14.84
29	TRANSMISSION SHAFT WITH NUT	*	*	*	*	M0000108-001	\$36.12
30	VERTICAL AUGER COMPLETE OF BUSHING	*	*	*	*	M0004111-001	\$55.00
31	VERTICAL AUGER BUSHING	*	*	*	*	B06.032INOX	\$5.80
32	PINION VERTICAL AUGER	*	*	*	*	M0004104-001	\$15.00
33	BUSHING TRANSMISSION SHAFT	*	*	*	*	M0000104-001	\$4.46
34	TRANSMISSION SHAFT WITH SLEEVE	*	*	*	*	M0000140-001	\$107.68
35	COTTER PIN	*	*	*	*	M0000117-001	\$1.00
36	TRANSMISSION SHAFT GASKET	*	*	*	*	M0000114-001	\$7.42
37	BLACK TERMINAL BOARD COMPLETE	*	*	*	*	M0005117-004	\$29.68
37a	BLACK COVER TERMINAL BOARD	*	*	*	*	M0000113-004	\$2.58

Part #	DESCRIPTION	FC1	FC2	FC3	115/60	MFG. #	Retail
38	BLACK REAR HINGE	*	*	*	*	M0006103-003	\$9.04
39	M5 SQUARE NUT	*	*	*	*	M0000120-001	\$2.38
40	SCREW TE 5X12MM	*	*	*	*	M0001101-001	\$1.54
41	RING NUT SHAFT FASTENING	*	*	*	*	M0000105-001	\$4.46
42b	GREY COMPLETE INOX TANK	*	*	*	*	M0002112-005	\$519.32
42c	BLACK COMPLETE INOX TANK	*	*	*	*	M0002112-004	\$519.32
43	ELECTRONIC THERMOSTAT PROBE	*	*	*	*	M0005114-001	\$27.72
44	RUBBER SLEEVE FOR THERMOSTAT	*	*	*	*	M0000127-001	\$8.34
45	HORIZONTAL AUGER GEAR	*	*	*	*	M0004105-001	\$15.00
46	HORIZONTAL AUGER COMPLETE OF BUSHING	*	*	*	*	M0004110-001	\$237.40
46a	HORIZONTAL AUGER BUSHING	*	*	*	*	M0004102-001	\$3.88
47	BLACK BASE	*	*	*	*	M0006116-003	\$9.04
48	BLACK HINGE HOOK	*	*	*	*	M0006102-003	\$12.90
49	BLACK FRONT HINGE	*	*	*	*	M0006115-003	\$12.90
50	LOCKING BOLT	*	*	*	*	M0006119-001	\$13.36
51	GEAR MOTOR	*	*	*	*	M0005104-001	\$322.56
52	SCREW 6X12	*	*	*	*	M0000122-001	\$0.64
53	OPTICAL SUPPORT	*	*	*	*	M0005119-001	\$23.22
54	RIVET 4X10	*	*	*	*	RIV4X7ALL	\$0.78
55	GRANI 3X5	*	*	*	*	GRANI3X5	\$1.54
56	OPTICAL READER DISK	*	*	*	*	A0005101-001	\$41.28
57	SCREW 2,9X16	*	*	*	*	VTTC2.9X13CR	\$0.78
58	OPTICAL READER	*	*	*	*	EOSW-9603	\$44.52
59a	COMPLETE GEAR MOTOR WITH OPTICAL READER	*	*	*	*	M0005118-001	\$378.00
59b	COMPLETE GEAR MOTOR WITH HALL SENSOR	*	*	*	*	M0005139-001	\$378.00
60a	FC1 ACCUMULATOR OLD CONFIGURATION	*			*	BOYLERBMCAP	\$104.50
60b	FC2 ACCUMULATOR (3MTX1.06MM)		*		*	BOYLERM2CAP	\$148.38
60c	FC3 ACCUMULATOR (5MTX1.06MM)			*	*	BOYLERM3CAP	\$193.54
61a	BACK STAINLESS STEEL PANEL WITH LOUVERS FC1 OLD CONFIGURATION	*			*	M0006112-001	\$87.74
61b	BACK STAINLESS STEEL PANEL WITH HOLES - FC1 NEW CONFIGURATION	*			*	M0106108-001	\$50.36
61c	BACK STAINLESS STEEL PANEL WITH LOUVERS		ST_A	ST_A	*	M0006112-001	\$87.74
62	SCREW 3.9X9.5	*	*	*	*	M0006124-001	\$0.64
63a	GREEN RIGHT SIDE	*	*	*	*	M0006106-001	\$59.36
63b	GREY RIGHT SIDE	*	*	*	*	M0006106-005	\$59.36
63c	BLACK RIGHT SIDE	*	*	*	*	M0006106-007	\$59.36
64a	RIGHT SIDE STAINLESS STEEL PANEL WITH LOUVERS	ST_A	ST_W	ST_W	*	M0006113-001	\$89.02
64b	RIGHT SIDE STAINLESS STEEL PANEL (CONDENSER SIDE)		ST_A	ST_A	*	M0006126-001	\$89.02
65	KNOB SIDE PANEL		*	*	*	A0006102-001	\$2.96
66	AIR FILTER		*	*	*	A0002103-001	\$3.98
67a	GREEN LEFT PLASTIC PANEL	*	*	*	*	M0006106-002	\$59.36
67b	GRAY LEFT PLASTIC PANEL	*	*	*	*	M0006106-006	\$59.36
67c	BLACK LEFT PLASTIC PANEL	*	*	*	*	M0006106-008	\$59.36
68	LEFT SIDE PANEL WITH LOUVERS AND MAIN SWITCH+PRESSURE SWITCH	ST_A	ST_A	ST_A	*	M0006135-001	\$68.38
69	MAIN SWITCH	*	*	*	*	I82L2206165	\$18.06
70	DRAIN SILICON TUBE ϕ 8X11MM	*	*	*	*	TSC8X11	\$8.38

Part #	DESCRIPTION	FC1	FC2	FC3	115/60	MFG. #	Retail
71	DRAIN PLASTIC CONNECTION	*	*	*	*	B06.031C	\$7.42
72	COMPRESSOR WARNING LIGHT 115V	*	*	*	*	A0005105-001	\$11.22
73	TRADITIONAL ELECTRONIC BOARD	ST_ALL	ST_ALL	ST_ALL	*	M0005127-001	\$321.26
74a	TRADITIONAL ELECTRICAL WIRING FC1	ST_ALL			*	M0105101-001	\$50.32
74b	TRADITIONAL ELECTRICAL WIRING FC2		ST_ALL		*	M0205101-001	\$65.80
74c	TRADITIONAL ELECTRICAL WIRING FC3			ST_ALL	*	M0305101-001	\$83.86
75	SCREW 2.9X9.5	*	*	*	*	M0005135-001	\$0.78
76	STAINLESS STEEL FRONT PANEL	*	*	*	*	M0006111-002	\$47.74
77a	GREEN DRIP TRAY	*	*	*	*	M0006110-001	\$29.68
77b	GRAY DRIP TRAY	*	*	*	*	M0006110-003	\$29.68
77c	BLACK DRIP TRAY	*	*	*	*	M0006110-004	\$29.68
78	STAINLESS STEEL DRIP TRAY	*	*	*	*	M0006117-001	\$33.54
79	RELAY CARRIER BOX FOR T2168GK 115V/60Hz		*	*	*	M0005101-002	\$89.02
80a	RELAY NE2125GK 115V/60Hz	*			*	CLI2283001	\$59.36
80b	RELAY T2168GK 115V/60Hz		*	*	*	CLI2302005	\$74.18
81a	START CAPACITOR T2168GK 115V/60Hz		*	*	*	COND2252084	\$74.18
81b	START CAPACITOR NE2125GK 115V/60Hz	*			*	COND2252096	\$74.18
82a	THERMAL PROTECTOR T2168GK 115V/60Hz		*	*	*	TER2297003	\$44.52
82b	THERMAL PROTECTOR NE2125GK 115V/60Hz	*			*	TER2321004	\$44.52
83	POWER CORD 115 V U.L. FOR USA	*	*	*	*	CAVOAL.UL15ALAV	\$33.54
84	SUPPRESSOR FILTER	*	*	*	*	FFLC560501	\$41.28
85	CONNECTION FOR SUPPLYING WIRING	*	*	*	*	M0005112-001	\$16.78
86	TRANSFORMER 60VA 115V	*	*	*	*	TZ92602TL60B	\$154.82
87a	COMPRESSOR T2168GK 115V/60HZ		ST_A	ST_A	*	C906DG2301AE	\$593.52
87b	COMPRESSOR NE2125GK 115V/60HZ	*			*	C9711G7166AE	\$741.90
88a	FUSE 5A 5X20		*	*	*	F11584	\$1.30
88b	FUSE 5A 5X20	*			*	F11584	\$1.30
89a	COIL WB8.0 110-120V/60HZ		*	*	*	A5605101-001	\$15.06
89b	COIL ZB09 110-120V/60HZ	*			*	A5105101-001	\$17.64
90	FUSE F315MA 5X20	*	*	*	*	A0005103-001	\$1.54
91a	FC1 BODY VALVE	*			*	CPM117FS	\$59.36
91b	FC2 BODY VALVE		*		*	CPM287ELS	\$180.64
91c	FC3 BODY VALVE			*	*	CPM387ELS	\$225.80
92	DRYER	*	*	*	*	FA032SBMM2M3	\$50.32
93a	FC PRESSURE SWITCH	*	*	*	*	A0002101-001	\$100.64
93b	PRESSURE SWITCH WITH CUPPER TEE	*	*	*	*	A0002104-001	\$101.92
94	CUPPER TEE	*	*	*	*	TEEDIRAMED6	\$1.30
95a	IRON CONDENSER STFT 16224		ST_A	ST_A	*	C082036007	\$203.94
95b	IRON CONDENSER STFT 14T 1R 145A" OLD CONFIGURATION FC1	*			*	M0102109-001	\$161.28
95c	IRON CONDENSER STFT 14T 2R 145A" OLD CONFIGURATION FC1	*			*	M0102111-001	\$116.52
96a	ALUMINUM FAN BLADE 172/34°	*			*	M0102110-001	\$7.42
96b	ALUMINUM FAN BLADE 254/25°		ST_A		*	V4012255	\$9.04
96c	ALUMINUM FAN BLADE 254/31°			ST_A	*	V4012016M3/2	\$9.30
97	TIMER SUPPORT	*	*	*	*	G0005102-001	\$25.80
98	TIMER 100-240V/50-60HZ	*	*	*	*	T027600231	\$199.98

Part #	DESCRIPTION	FC1	FC2	FC3	115/60	MFG. #	Retail
99	FAN MOTOR 10W 115V/50-60HZ	*			*	M40601950	\$68.96
99	FAN MOTOR 16W 115-230V/60HZ		ST_A	ST_A	*	M4860059	\$113.54
100	DRIP TRAY BRACKET	*	*	*	*	M0001104-001	\$23.22
101	SMALL RUBBER FEET	*	*	*	*	PAR114-ELGR	\$5.80
102	U.S.A. FEET		*	*	*	A5601101-001	\$33.54
103a	M6 NUT	*			*	DADOD.6ZFL	\$0.78
103b	M8 NUT		*	*	*	DADOD.8ZFL	\$0.78
104a	SCREW 6X12	*			*	VTTE6X12Z	\$0.78
104b	SCREW 8X16		*	*	*	VTTE8X16Z	\$0.78
105	BOARD BOX	*	*	*	*	M0005134-001	\$10.32
107	OUTLET RESTRICTION	*	*	*	*	M0003130-001	\$17.48
108	FREON VALVE RECHARGE	*	*	*	*	VALVSALDARE	\$29.98
109	WASHER FOR GEAR MOTOR'S SCREW D.6,3	*	*	*	*	M0000144-001	\$0.64
110	PRESSURE SWITCH CONNECTION WIRES	*	*	*	*	A0005110-001	\$2.40
111	CONNECTION WIRES COVERING BAG	*	*	*	*	M0000124-001	\$0.46
112	ELECTRICAL KIT OF CONDENSERS FOR POWER FACTOR IMPROVEMENT			*	*	M0005142-001	\$2.78
113	CONDENSER FOR POWER FACTOR IMPROVEMENT			*	*	M0005141-001	\$27.26
114a	NEGATIVE TEMPERATURE CONTROL TRIMMER	*	*	*	*	M0005144-001	\$83.16
114b	POSITIVE TEMPERATURE CONTROL TRIMMER	*	*	*	*	M0005143-001	\$55.44
115	MAXIMUM LEVEL STICKERS	*	*	*	*	A0006103-001	\$0.74
116	SCREW 2.2X9.5	*	*	*	*	VTTC2.2X9.5CR	\$0.78
117	FC1 NEW CONFIGURATION CAPILLARY 0,91MX2,75MT	*			*	A0002105-001	\$4.16
118	POWER CORD SCREW TERMINAL BOARD		*	*	*	M0005151-001	\$10.40
150	C\BODY PIPE NUT 1/4 COD. PDFG220000		ST_REF	ST_REF	*	A0000107-001	\$3.00
152	GUM KEEPING JUNCTION		ST_REF	ST_REF	*	A0000103-001	\$37.48
153	1/4 C\BODY PIPE WITH VALVE COD. 9C050713P1		ST_REF	ST_REF	*	A0000102-001	\$24.98
154	PIPE 6X12 FOR REFILL COD. 797344		ST_REF	ST_REF	*	A0000101-001	\$8.90
155	COIL 115V		ST_REF	ST_REF	*	A5000103-001	\$25.82
156	CLIP PFAS13/15		ST_REF	ST_REF	*	A0000104-001	\$43.18
157	REFILL VALVE 21L1K1V25 120/60 12W UL		ST_REF	ST_REF	*	A5000102-001	\$196.36
158a	90° PLASTIC ELBOW FOR SOLENOID VALVE		ST_REF	ST_REF	*	A0000106-001	\$16.98
158b	90° STAINLESS STEEL ELBOW FOR SOLENOID VALVE		ST_REF	ST_REF	*		\$23.50
159	4X8 PLATED SCREW		ST_REF	ST_REF	*	A0001101-001	\$0.24
160	REFILL KIT FOR FIRST CLASS - MACH		ST_REF	ST_REF	*	M0005130-001	\$172.38
161	NOTCHED WASHER 5.3 E		ST_REF	ST_REF	*	ROND.D.5.3EDENT	\$0.74
163a	FC2 REFILL TRADITIONAL ELECTRICAL WIRING		ST_REF		*	M0205102-001	\$18.08
163b	FC3 REFILL TRADITIONAL ELECTRICAL WIRING			ST_REF	*	M0305102-001	\$18.08
164	MOLEX CONNECTOR FOR MAIN SWITCH	*	*	*	*	A0005106-001	\$1.98